

BOLT HEAD WILL HAVE MANUFACTURER'S ID MARK AND A "CW" MARK FOR COLD WEATHER APPROVED BOLTS

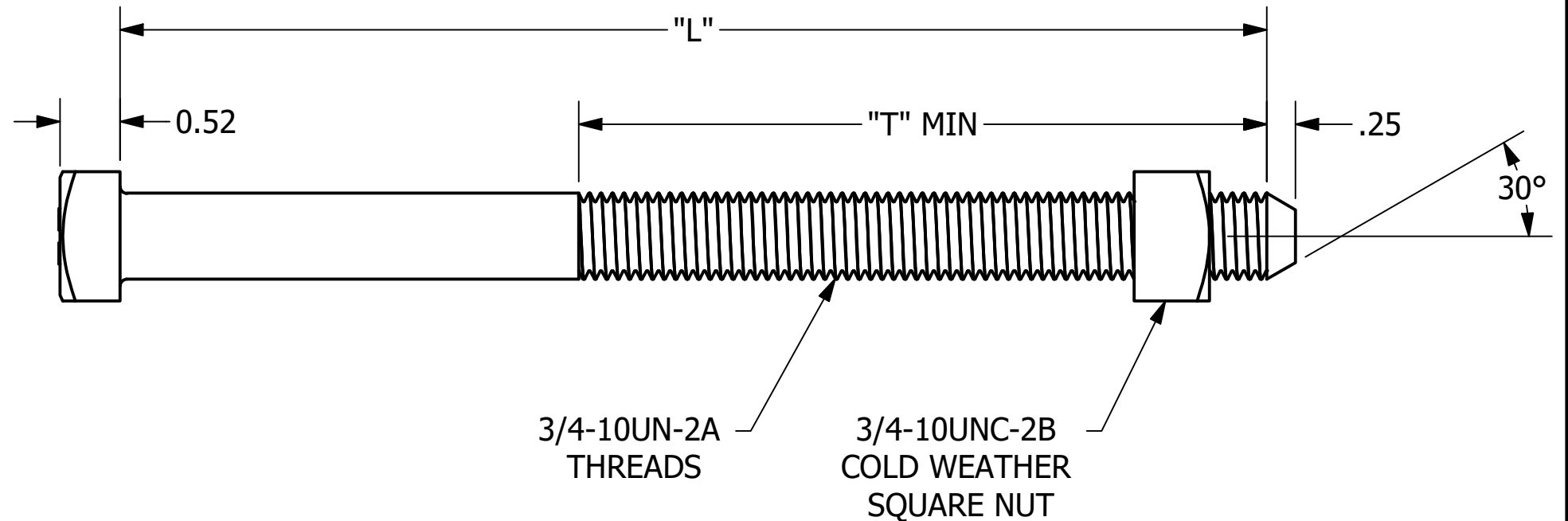
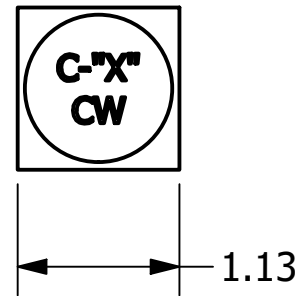

| CATALOG NUMBER | "L" | "T" |
|----------------|-----|------|
| PS8902CW | 2 | 1.38 |
| PS890212CW | 2.5 | 1.38 |
| PS8906CW | 6 | 3 |
| PS8907CW | 7 | 4 |
| PS8908CW | 8 | 4 |
| PS8910CW | 10 | 6 |
| PS8912CW | 12 | 6 |
| PS8914CW | 14 | 6 |
| PS8916CW | 16 | 6 |
| PS8918CW | 18 | 6 |
| PS8920CW | 20 | 6 |
| PS8922CW | 22 | 6 |
| PS8924CW | 24 | 6 |
| PS8926CW | 26 | 6 |
| PS8928CW | 28 | 6 |
| PS8930CW | 30 | 6 |

- NOTES -

- MATERIAL: STEEL CONFORMING TO THE FOLLOWING PROPERTIES:
 - AVERAGE MINIMUM ENERGY ABSORPTION OF 20J WHEN TESTED AT -20°C PER ASTM A370.
 - MINIMUM ASSEMBLY BREAKING STRENGTH OF 89.2 KN (20,053 LBS) WHEN TESTED PER ASTM F606.
 - UNTHREADED PORTION CAPABLE OF BEING BENT (COLD) AROUND A MANDREL WITHOUT CRACKING.
 - BOLT HEAD MUST WITHSTAND AN IMPACT BLOW AT A TEMPERATURE OF -20°C OR BELOW, PRODUCING A PERMANENT DEFORMATION OF 5° RELATIVE TO THE BOLT AXIS WITHOUT ANY CRACKS OCCURRING.
 - CHEMICAL COMPOSITION PER CSA C83.
- FINISH: HOT DIP GALVANIZED PER CSA G164.
- NUT DIMENSIONS PER ASME/ANSI B18.2.2.
- BOLTS 8" LONG AND UNDER SHALL BE AS SHOWN IN ASME B18.2.1 (LIMITED OR NO CHAMFER).

| | | | |
|---|---|---|---------------------------------|
| CHANCE [®] | HUBBELL POWER SYSTEMS, INC. | | |
| | TITLE BOLTS, MACHINE, 3/4" (COLD WEATHER CSA) | | |
| CONFIDENTIAL: THIS DRAWING AND ITS CONTENTS ARE CONFIDENTIAL AND THE EXCLUSIVE PROPERTY OF HUBBELL POWER SYSTEMS. NO PUBLICATION, DISTRIBUTION, OR COPIES MAY BE MADE WITHOUT THE WRITTEN CONSENT OF HUBBELL POWER SYSTEMS. HUBBELL POWER SYSTEMS UNPUBLISHED ALL RIGHTS RESERVED UNDER THE COPYRIGHT LAWS. | SIZE B | CAT / PART / ASSY NO. SEE TABLE | DWG NO. SAPS8908CW |
| DO NOT SCALE THIS DRAWING | DRN BY TOLIVER | DATE 8/16/21 | REV J SHEET 1 OF 1 |